

# SCR Lite Insulated Sliding Door

For chill & freezer application

Doors for cold-storage rooms



The "Lite" version of the SCR track has been designed with cost effectiveness in mind. It still has the same leaf strength as the SCR door but the frame dimensions are reduced to accommodate a sleeker, slimline, sliding system that has no carriage but a smoother operation for reduced door openings.

Stainless steel hanging bolts carry arnite wheels with stainless steel ball bearings and give this lightweight sliding system its smooth operation. The door is suitable for chill & freezer applications with frame & floor



GRUPO  
**repro**



Suspension set

The brushed frame profile can be prepared to install onto insulated panel or blockwork openings. The chamfered leaf surround and sliding door track has a T5-treatment and a 20 micron stainless steel coating that provides outstanding durability against the most aggressive of wash-down facilities.

Special industrial internal and external stainless steel handle.



www.bluseal.co.uk

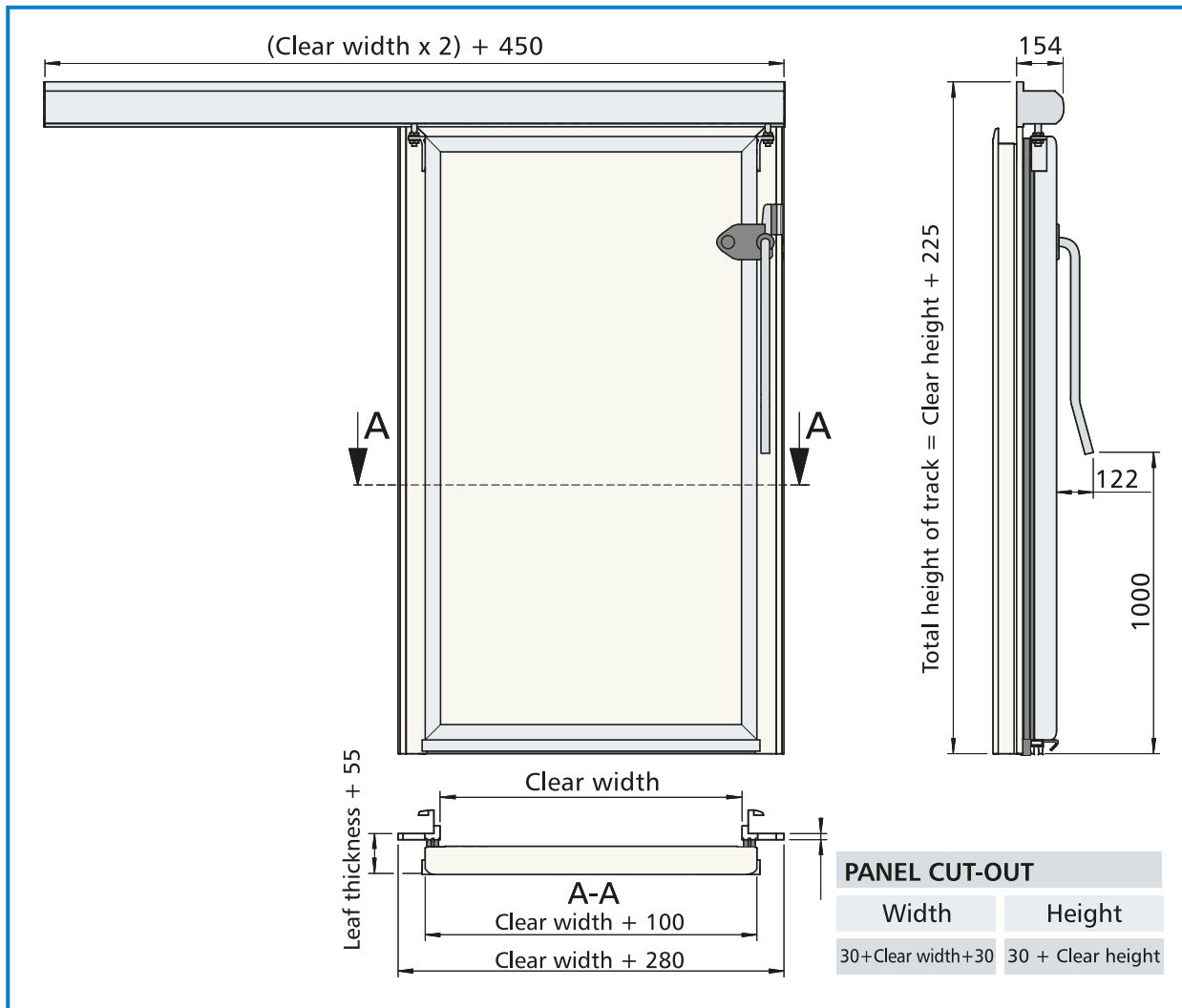

### SCR Lite Insulated Sliding Door Specification:

- The leaf finish is available in a range of RAL colours, PVC coated steel or stainless steel.
- Injected polyurethane insulation with a conductivity coefficient of 0.022 w/m<sup>2</sup>°C.
- Polyurethane with a density of 40-45 kg/m<sup>3</sup>.
- 0.6mm steel thickness for all finishes except polyester which is 3mm.
- Standard T5-treated anodised aluminium frame with 15 micron stainless steel finish, also available in any RAL colour or stainless steel
- All leaves are injected with insulation, to bespoke dimensions, and we are able to offer 80mm, 100mm and 120mm leaf thicknesses.
- Hygienic leaf & frame with no visible fixings.
- Grey plastic thermal break to face frame.
- Vision panels can be supplied to any dimension with double and triple glazed units for above 0°C and with heated glass for negative temperatures.
- Door protection is available in stainless steel, 5-bar aluminium or 8mm white polyethylene; as are painted steel, polypropylene or stainless steel goalposts and side gates.
- SCR automatic sliding system has a range of safety features including photocell technology and 'soft-closing' function.

**Bluseal**   
THE SEAL OF APPROVAL



GRUPO  
repro

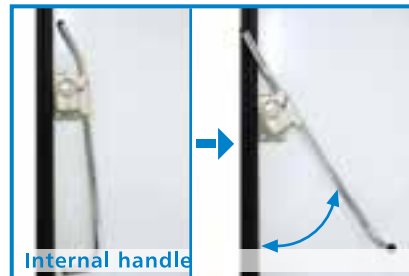

GRUPO  
repro